

GOLDAIR

Electric Knife

Model GEK200

OPERATING INSTRUCTIONS



GEK200: 220-240V, 50Hz, 100W

Thank you for choosing this GOLDAIR Electric Knife. This GOLDAIR appliance has been designed and manufactured to the highest standard and with proper use and care, as described in this leaflet, will give you years of useful service. Please read these instructions carefully.

GENERAL CARE AND SAFETY GUIDE

Please read all instructions carefully before using this appliance and keep them for future reference.

ALWAYS

- ✓ Always ensure hands are dry before handling the plug or the Electric Knife
- ✓ Always operate the Electric Knife on a secure, dry, level surface.
- ✓ Always allow adequate air space above and on all sides for air circulation. Do not allow the Electric Knife to touch clothing, dishtowels or other items during use. Do not use under cupboards.
- ✓ Always be sure to unplug from the socket when not in use and before cleaning.
- ✓ Always allow the Electric Knife to cool before cleaning and storing.
- ✓ Carry out regular checks of the supply cord to ensure no damage is evident.
- ✓ Return the Electric Knife after a malfunction, or if it has been damaged in any manner to an authorised service technician for examination, repair or adjustment as special purpose tools are required.
- ✓ Switch off the appliance and disconnect from supply before changing accessories or approaching parts that move in use.

NEVER

- ✗ Never touch hot surfaces.
- ✗ Never use this appliance outdoors.
- ✗ Never use this appliance for any purpose other than its intended use. This appliance is for household use only.
- ✗ This appliance is not intended for use by persons (including children) with reduced physical, sensory or mental capabilities or lack of experience and knowledge, unless they are supervised or have been given instruction concerning the use of the Electric Knife by a person responsible for their safety.
- ✗ Close supervision is necessary when the appliance is near children.
- ✗ Never leave the appliance unattended.
- ✗ Never allow the power cord to overhang the edge of a table or bench top or touch any hot surface.
- ✗ Never place this appliance on or near a hot gas or electric burner or where it could touch a heated oven or microwave oven.
- ✗ Never immerse the Electric Knife cord set or plug in water or any other liquid to protect against electrical hazards.
- ✗ Never place the Electric Knife body in a dishwasher.
- ✗ Never operate the appliance with a damaged cord or plug, after it malfunctions, or if it has been damaged in any manner.
- ✗ The Electric Knife is not intended to be operated by means of an external timer or separate remote-control system. The use of an extension cord is not recommended.

DO NOT OPERATE THE ELECTRIC KNIFE FOR MORE THAN 9 MINUTES AT A TIME

COMPONENTS

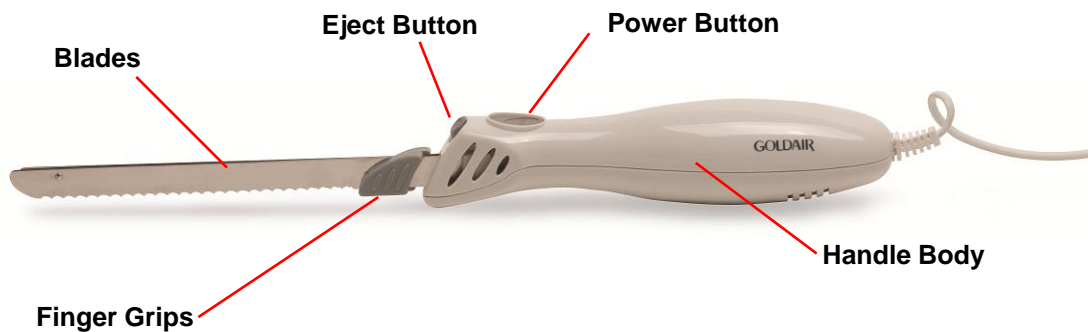

PLEASE KEEP THIS MANUAL FOR FUTURE REFERENCE

OPERATING YOUR ELECTRIC KNIFE

CAUTION: The cord must be unplugged before inserting or removing blades.

1. Before first use, wash the blades in hot, soapy water or in the dishwasher. Rinse and dry thoroughly. Slip the rivet at the tip of one blade into the Keyhole slot on other.
2. When inserting or removing blades, always be sure the cord is unplugged.
3. With the cutting (serrated) edge facing AWAY from your hand, grab the blades by the finger grips and insert the two ends of the blades into the slots of the handle. The blades will “click” into place. Plug the cord into an electrical outlet. Position the food to be sliced on a cutting board.
4. Press the power switch and guide the knife blades down through the food.

CAUTION: NEVER place your hand over the blade to support it while operating this knife. The blades are designed to slide back and forth for cutting.

REMOVING BLADES

To remove the blades you must unplug the cord first. Press the blade release button and grasp the blades by the finger grips with the cutting edge facing AWAY from your hand and pull out away from the handle.

CAUTION: THE ELECTRIC KNIFE MAY BECOME HOT DURING OPERATION.

DO NOT OPERATE THE ELECTRIC KNIFE FOR MORE THAN 9 MINUTES AT A TIME.

CARE AND CLEANING

1. Before cleaning any part of the electric knife. Unplug the cord, and remove the blades.
2. Knife blades may be washed in hot soapy water or in the dishwasher. Dry all parts thoroughly before next use.
3. The knife handle and cord may be cleaned with a damp cloth. **DO NOT** use any abrasive cleanser or material to clean any part of the knife as it may harm the finish. Do not put the knife handle in water

AFTER SALES SERVICE

This appliance is built to the very highest of standards. There are no user-serviceable parts. Follow these steps if the unit fails to operate:

- Check instructions have been followed correctly.
- Check mains supply is functional.

If the appliance will not operate, return the appliance to the place it was purchased with your receipt for a replacement.

GOLDAIR

SUPPORT AND TECHNICAL ADVICE

North Shore City, Auckland, New Zealand
Monday – Friday 8am-5pm
Phone: 0800 232 633
Website: www.goldair.co.nz

GOLDAIR

Your GOLDAIR product has been inspected and tested and is guaranteed subject to the following for a period of two years from the date of purchase against defects in workmanship and materials. During this period, such defects will be rectified by repair or replacement of the product purchased. Your product contains no user serviceable components and this warranty becomes invalid if in our opinion the product has been misused, abused, incorrectly installed, tampered with, connected to an electrical supply not corresponding with the name plate specification, or subjected to power surges. The warranty does not include any labour or other associated expense that may be involved in removal or installation of the product. Normal wear and tear is expressly excluded.

If your GOLDAIR product fails to operate satisfactorily, please return it to the retailer from whom it was purchased. To obtain a repair or replacement product under this warranty, you will need to produce satisfactory evidence of date of purchase. The completed warranty and purchase receipt must be presented with the product. The warranty should be filled out at the time of purchase. It is in your interest to make sure this is done.

If the product is to be replaced (cannot be repaired) then that replacement will be of the faulty product or accessory excluding packaging, instruction card etc. Where a replacement product is supplied, this shall be guaranteed for the balance of the original warranty period.

Any model that is no longer available will be replaced by a model of a value and with such features as we consider appropriate in the circumstances. Goldair Ltd is not responsible for freight forwarding charges, losses or damage in transit.

If service is required after the warranty period has expired, the product should be returned to a qualified electrical technician. Service outside of the warranty period will be at your cost.

Consumers Guarantee Act (1993).

In accordance with the above act consumers are advised that: The manufacturer does not undertake repair facilities and parts are necessarily available for this product.

If any of the provisions of the foregoing are contrary to any relevant legislation, then that provision shall be deemed to be excluded from the warranty and the rest of the provisions will continue to apply.

TWO YEAR WARRANTY

IMPORTANT: PLEASE RETAIN THIS WARRANTY CARD

NAME: _____
ADDRESS: _____
PURCHASED FROM: _____
SUBURB: _____
DATE OF PURCHASE: _____
NAME OF PRODUCT: _____
MODEL No: _____